



**SE BEND SEPTIC TO SEWER
ADVISORY COMMITTEE MEETING**

THURSDAY, AUGUST 10, 2017

WELCOME & INTRODUCTIONS

- Committee Administration
- Tour Follow-up
- City Finances
- Committee Q&A
- Septic System Finances
- Look Ahead: Solutions in Peer Communities
“What would you like know?”
- Public Comment

COMMITTEE ADMINISTRATION



- Beth Bicknase—Chair
- Scott Johnson—Vice-Chair

The Chair/Vice Chair will work with staff to help develop meeting agendas, review presentation materials and provide recommendations on other topics relevant to the Committee's work.

TOUR FOLLOW-UP

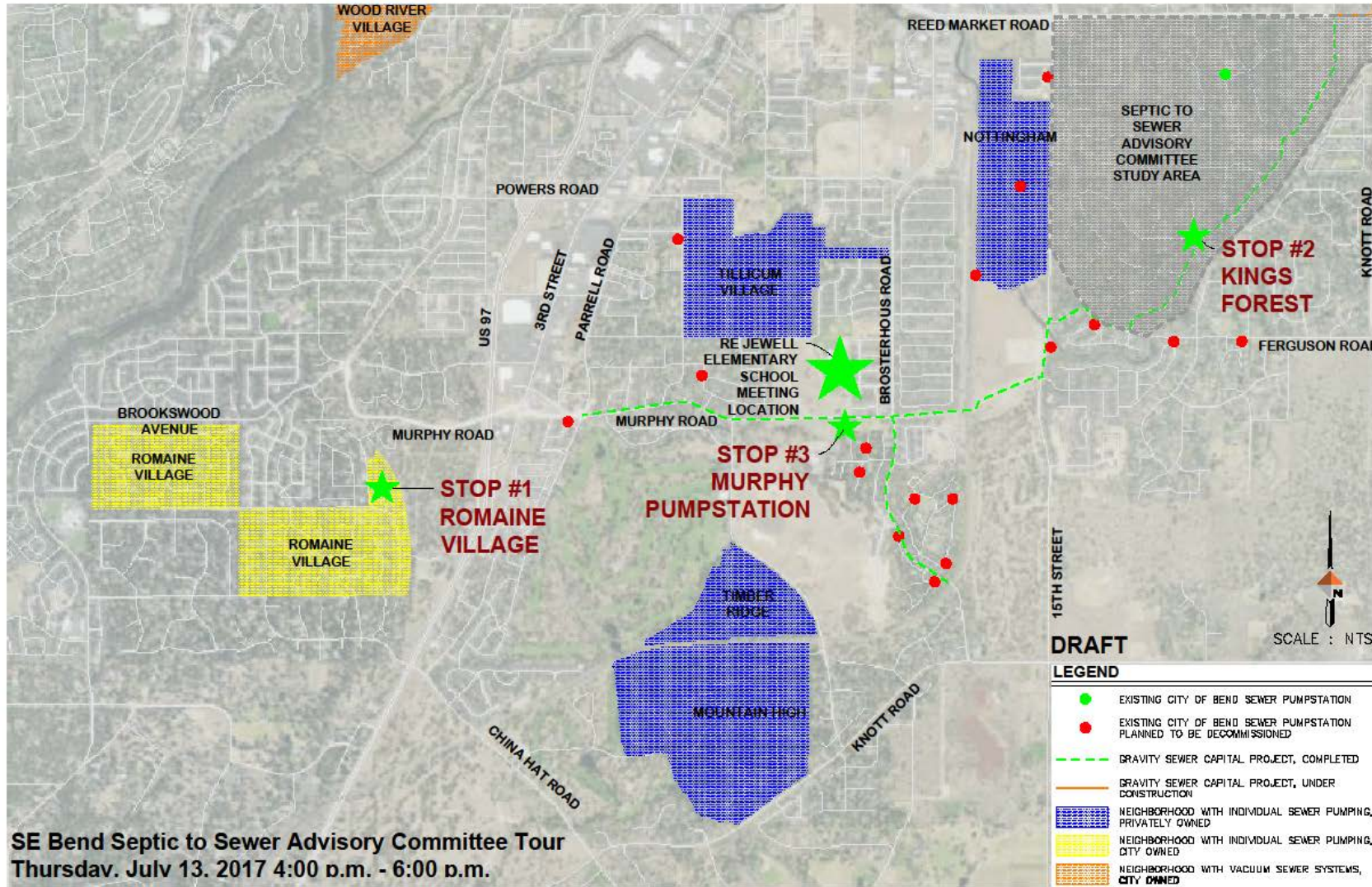

SOUTHEAST INTERCEPTOR (SEI)



- SEI provides relief for capacity issues in southwest, southeast, northeast, and central areas.
- Endorsed by SIAG as a priority project.
- Enables gravity sewer service for most of the study area.





1. Gravity Sewer Connection

- Gravity sewer service from the home to SEI – no pump

2. Home Pump to Gravity

- Individual sewer pumping stations owned and maintained by the homeowner
- Pumped from home to gravity sewer pipe

3. Home Pump to Pressure

- Individual sewer pumping stations owned and maintained by the homeowner.
- Pumped from home to pressure sewer pipe

1. GRAVITY SEWER CONNECTION



Gravity sewer service from the home to SEI—no pump

Higher initial cost; lower ongoing O&M cost

Initial Investment	\$\$\$
Homeowner O&M	\$
City O&M	\$

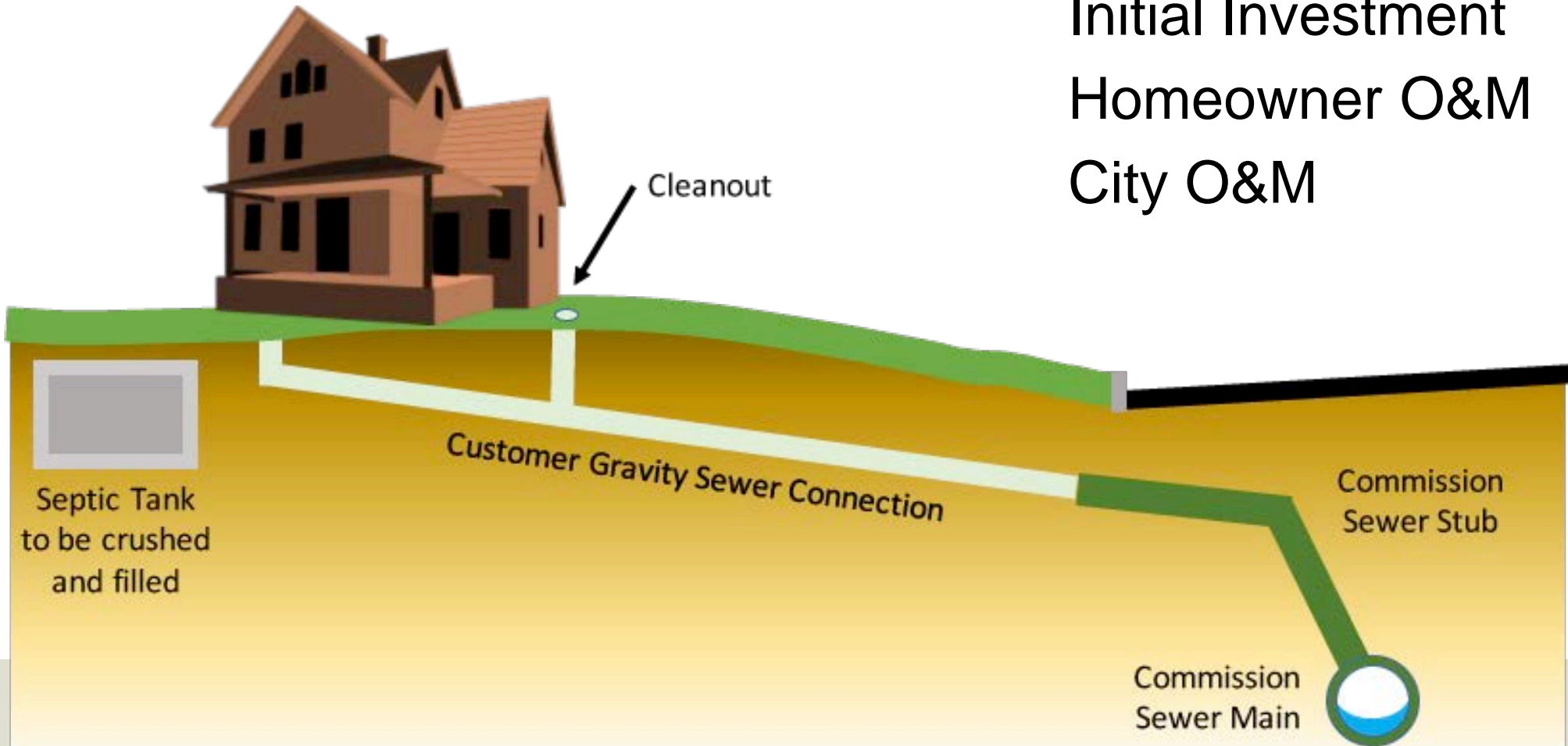



2. HOME PUMP TO GRAVITY

Pumped from home to gravity sewer pipe that flows to SEI

Lower initial cost; higher O&M cost for homeowners

Initial Investment	\$\$
Homeowner O&M	\$\$\$
City O&M	\$

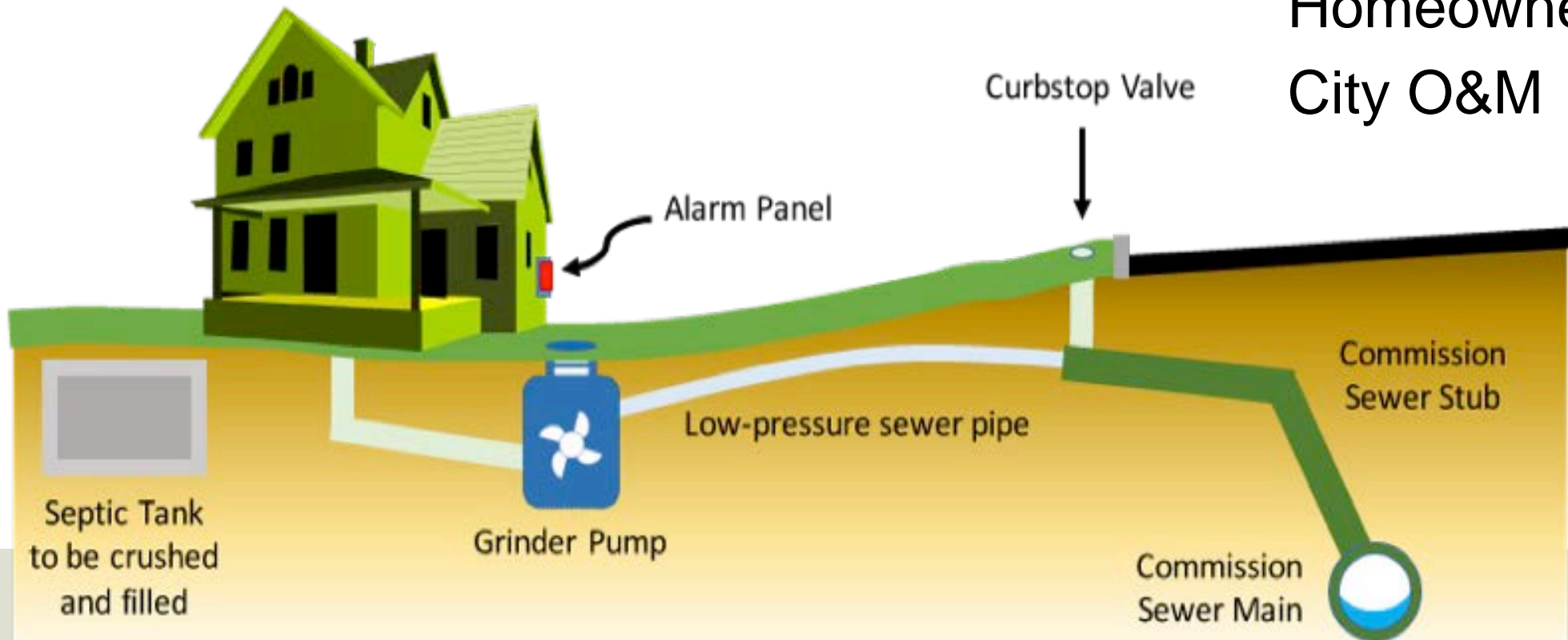

3. HOME PUMP TO PRESSURE



Pumped from home to pressure sewer pipe that connects to SEI

Lower initial cost; higher O&M cost for homeowners and City

Initial Investment	\$
Homeowner O&M	\$\$\$
City O&M	\$\$

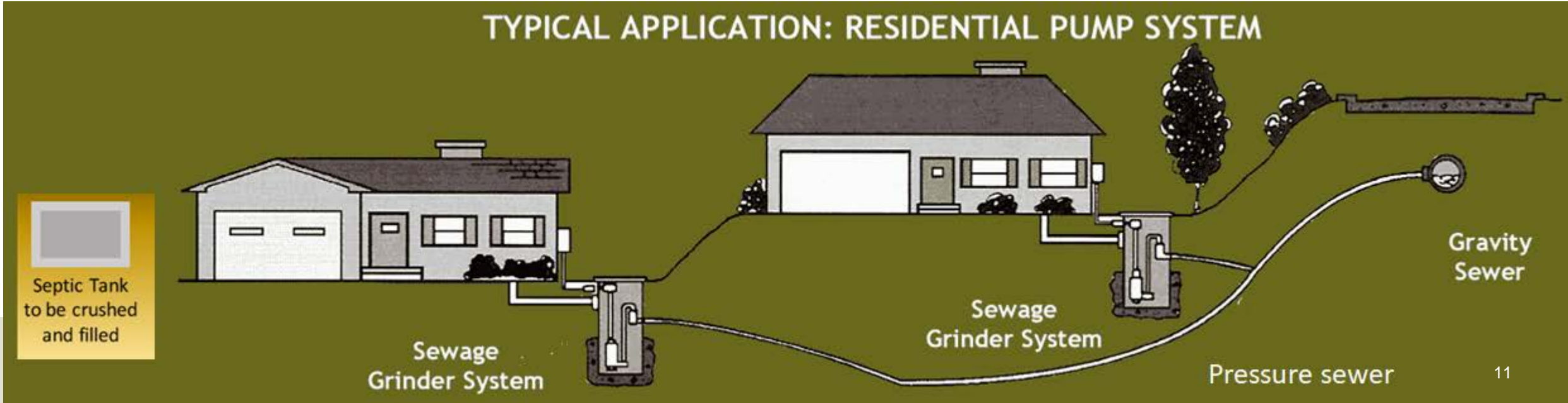

CITY FINANCES



KEY TAKEAWAYS



General Fund revenue, including Property Taxes, is not available for Sewer Fund use.

All other funds have restricted revenues that cannot be used in the Sewer Fund.

CITY SERVICES AND OUR BUDGET



FUND ACCOUNTING

THE GENERAL FUND



- Property Taxes
- Franchise Fees
- Room Taxes
- State Shared Revenue

For all general government activities not in a special fund

RESTRICTED REVENUE FUNDS

- **Special Revenue Funds**
- **Enterprise Funds**



WHERE DOES YOUR PROPERTY TAX DOLLAR GO?



GENERAL FUND REVENUE, INCLUDING PROPERTY TAXES, IS NOT AVAILABLE FOR SEWER FUND USE.



Funding Sources for Primary Programs

- Rate & Fee Supported
- General Fund Supported
- Cost Allocated (paid through transfers from other funds)

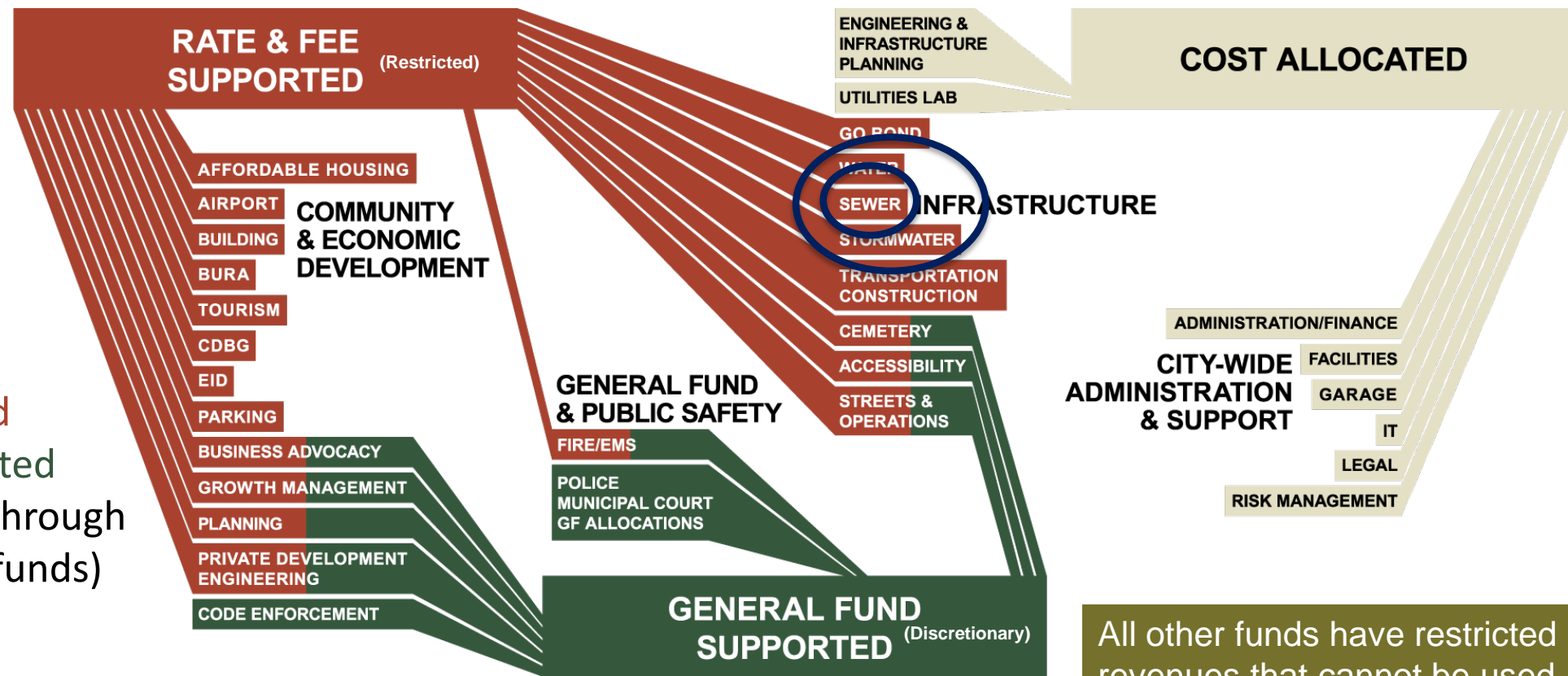

All other funds have restricted revenues that cannot be used in the Sewer Fund.

GENERAL FUND AND CITY-WIDE REVENUE FOR FY 2017-18

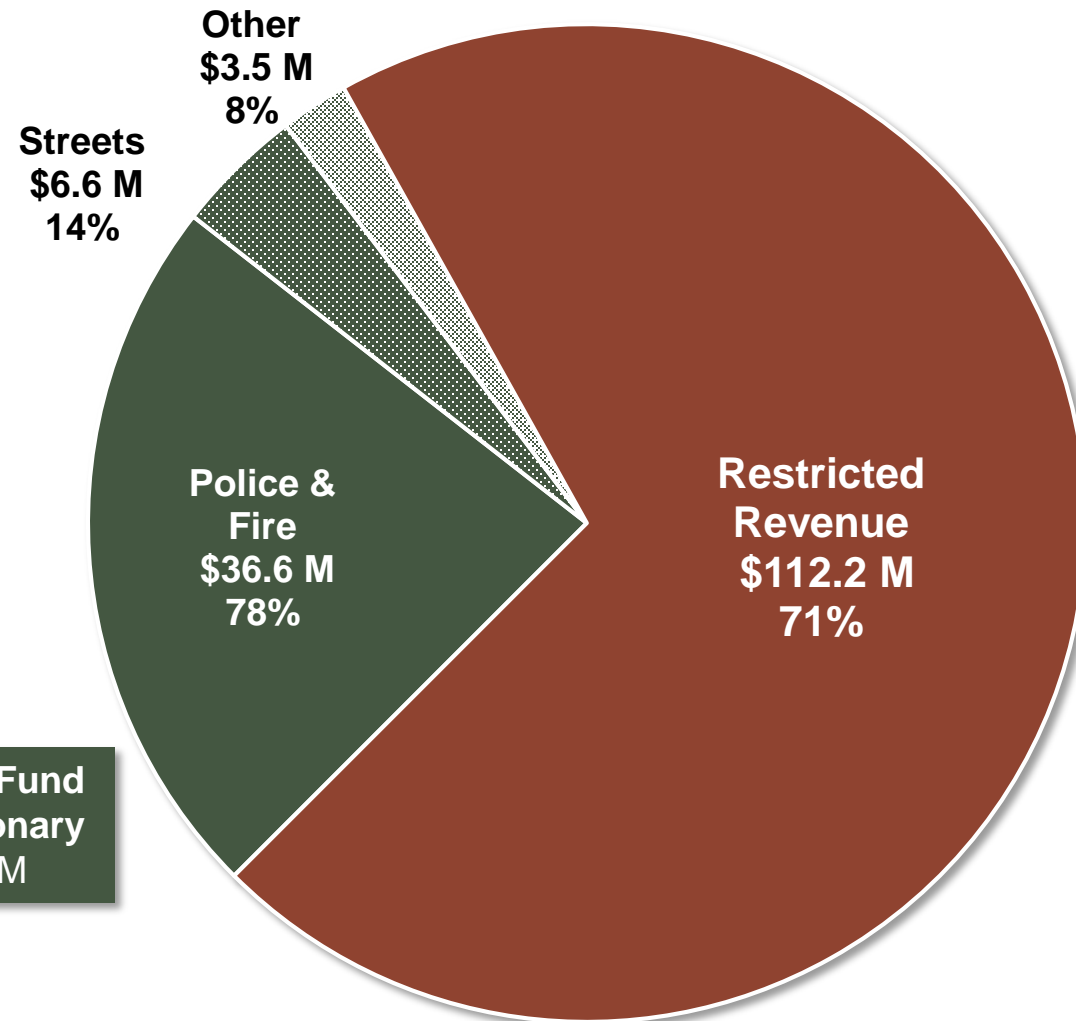

Total Revenue*
\$158.9M

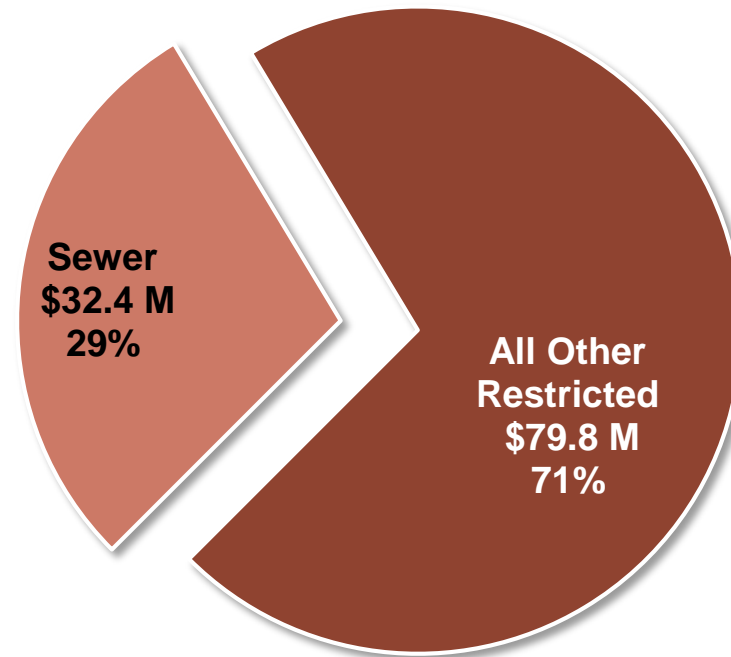

*Revenue excludes debt proceeds & transfer revenue.

SEWER UTILITY FUNDING



SEWER FY 2017-18 EXPENDITURES



Total Expenditures
\$68.1M

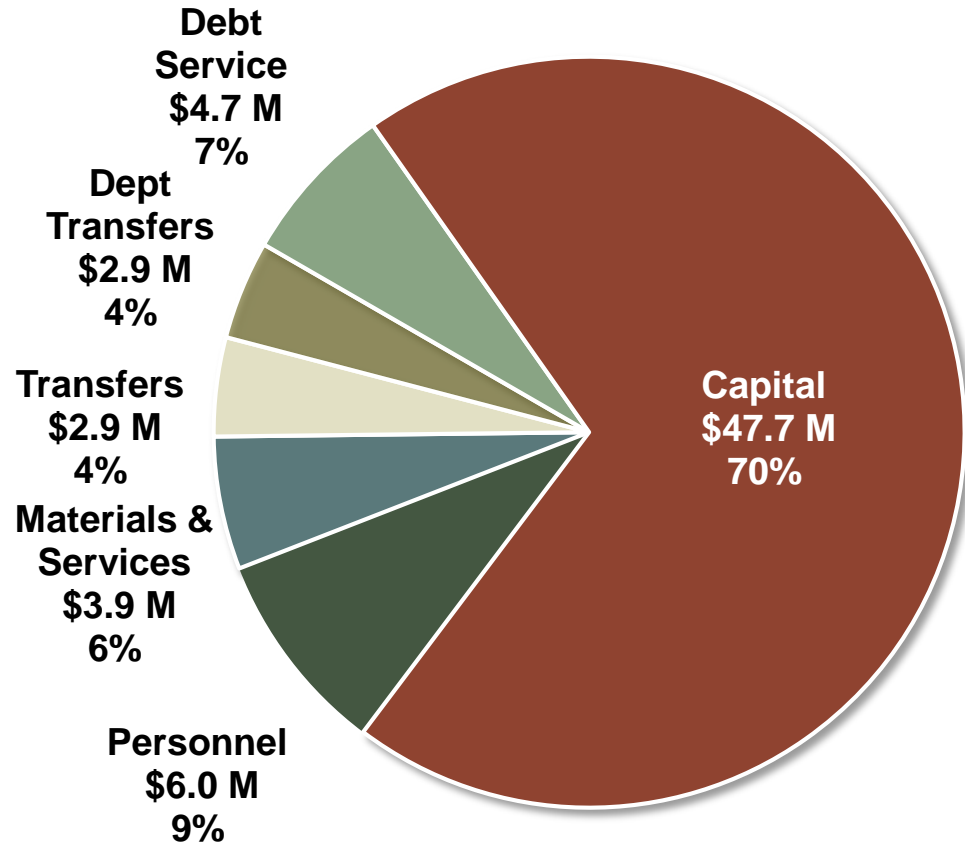
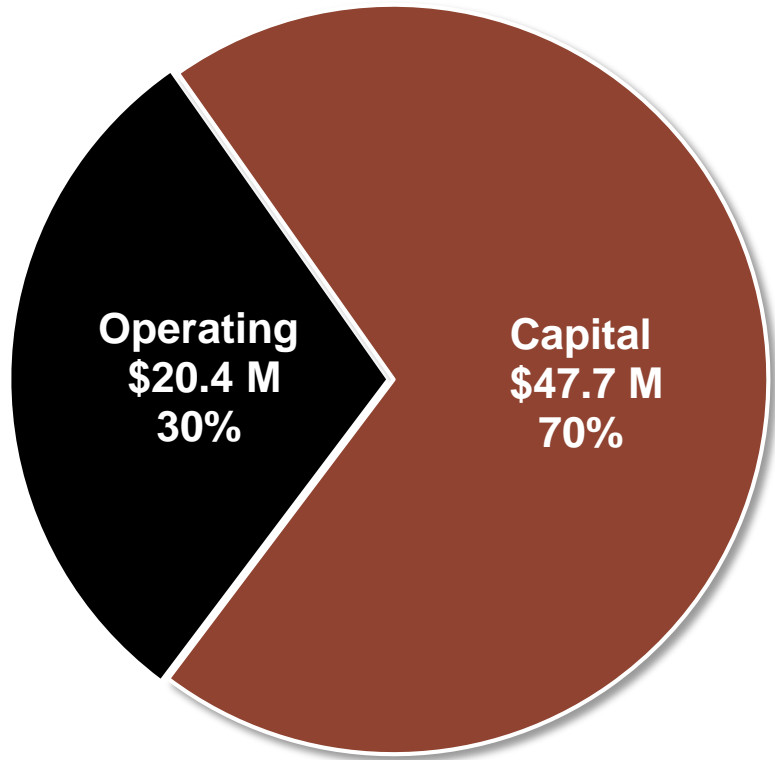



FINANCING CAPITAL PROJECTS



Determine Need

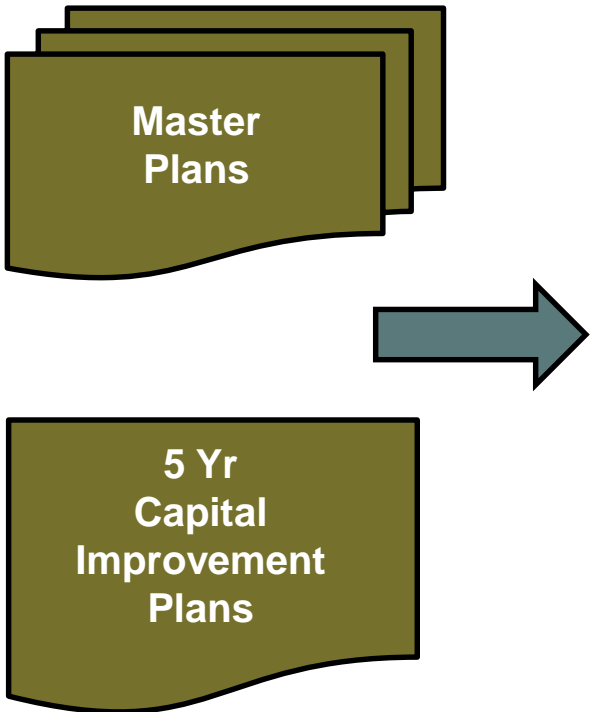

How do we fund and finance?

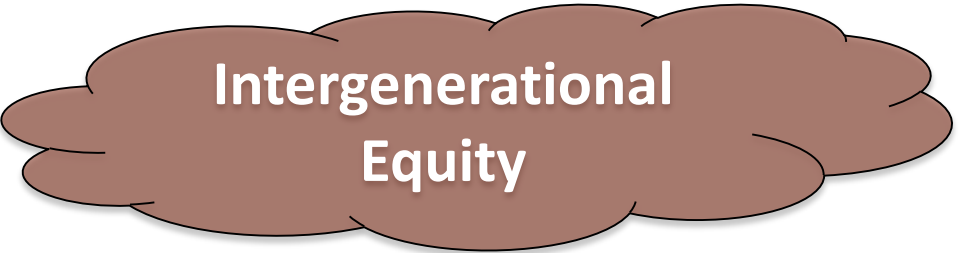
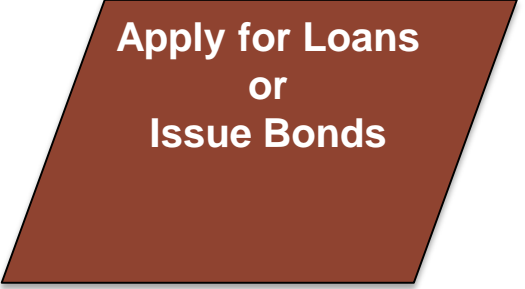
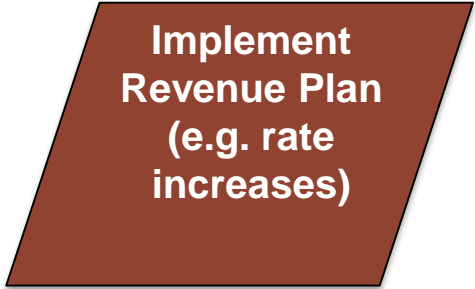
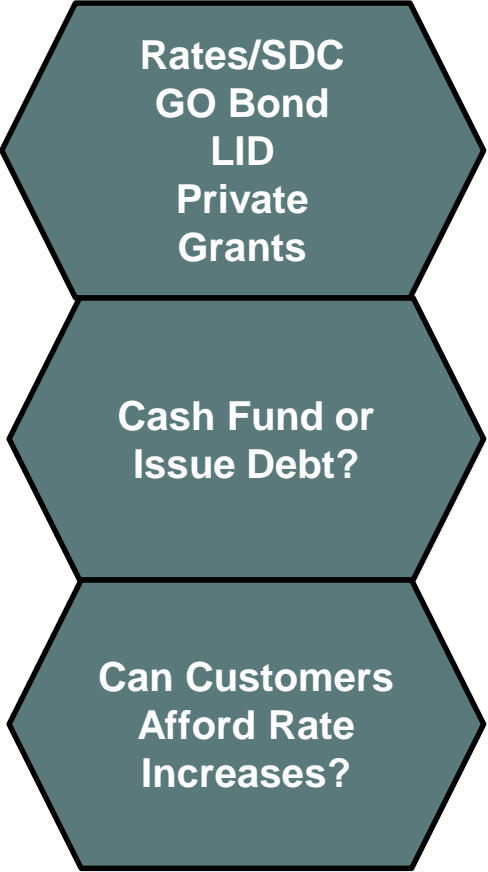

SEWER FY 2017-18 REVENUE



Total Revenue
\$68.1M

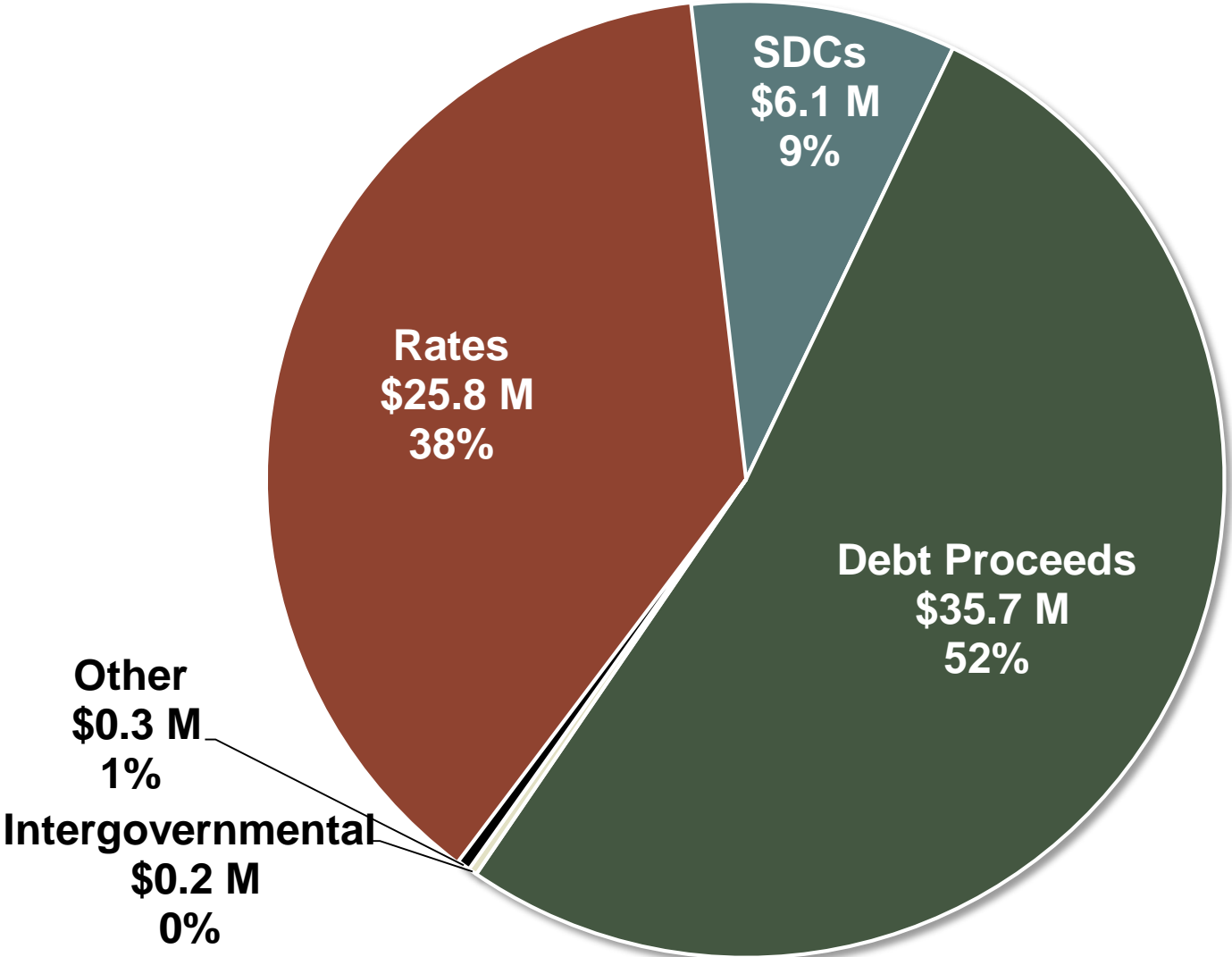



KEY TAKEAWAYS



General Fund revenue, including Property Taxes, is not available for Sewer Fund use.

All other funds have restricted revenues that cannot be used in the Sewer Fund.

COMMITTEE Q&A

SEPTIC SYSTEM FINANCES

SEPTIC SYSTEM COMPONENTS

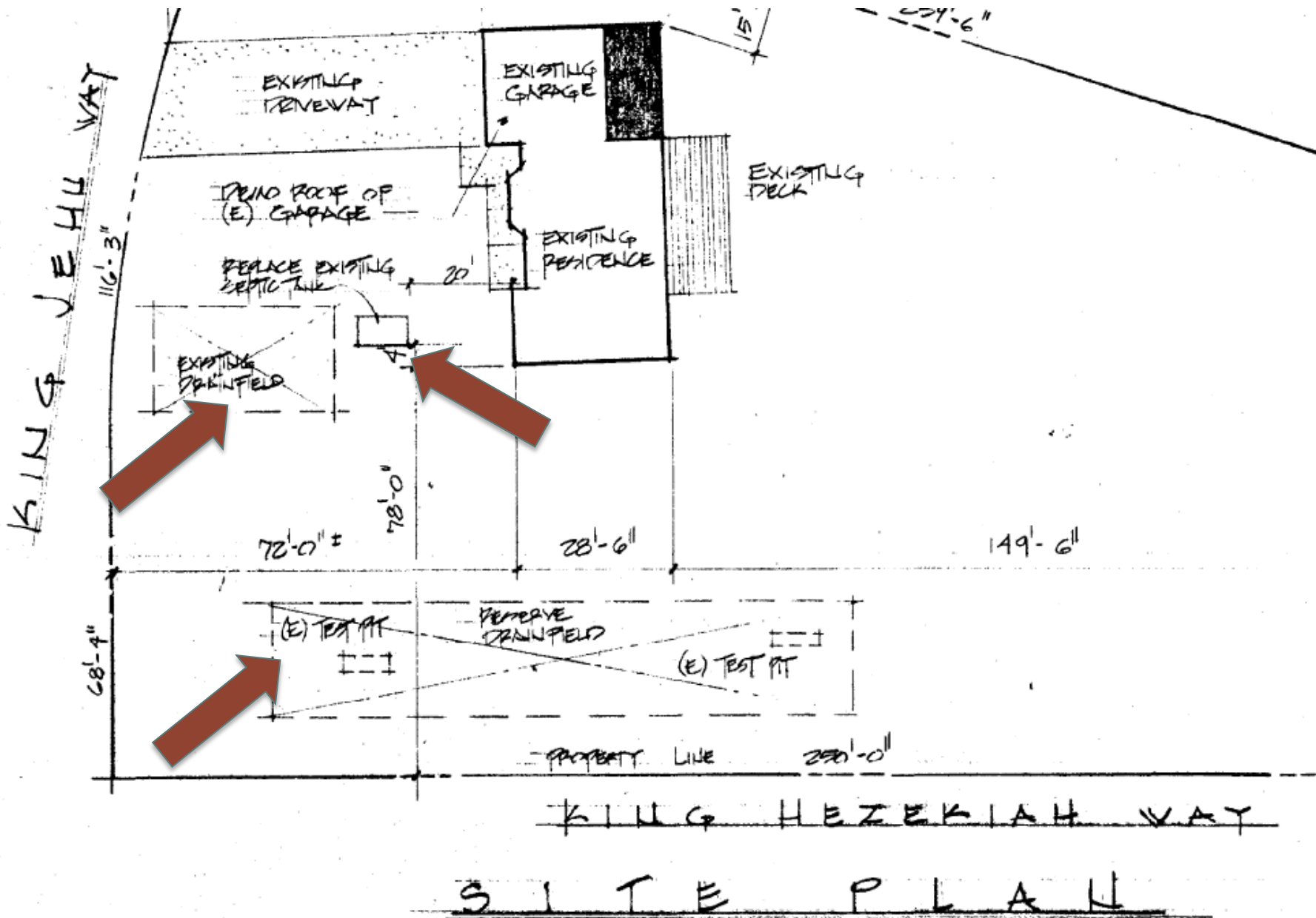

NEW SEPTIC SYSTEM INSTALLATION



Typical Standard Residential Septic Installation

Initial Capital Costs:

\$5,500 - \$6,500*

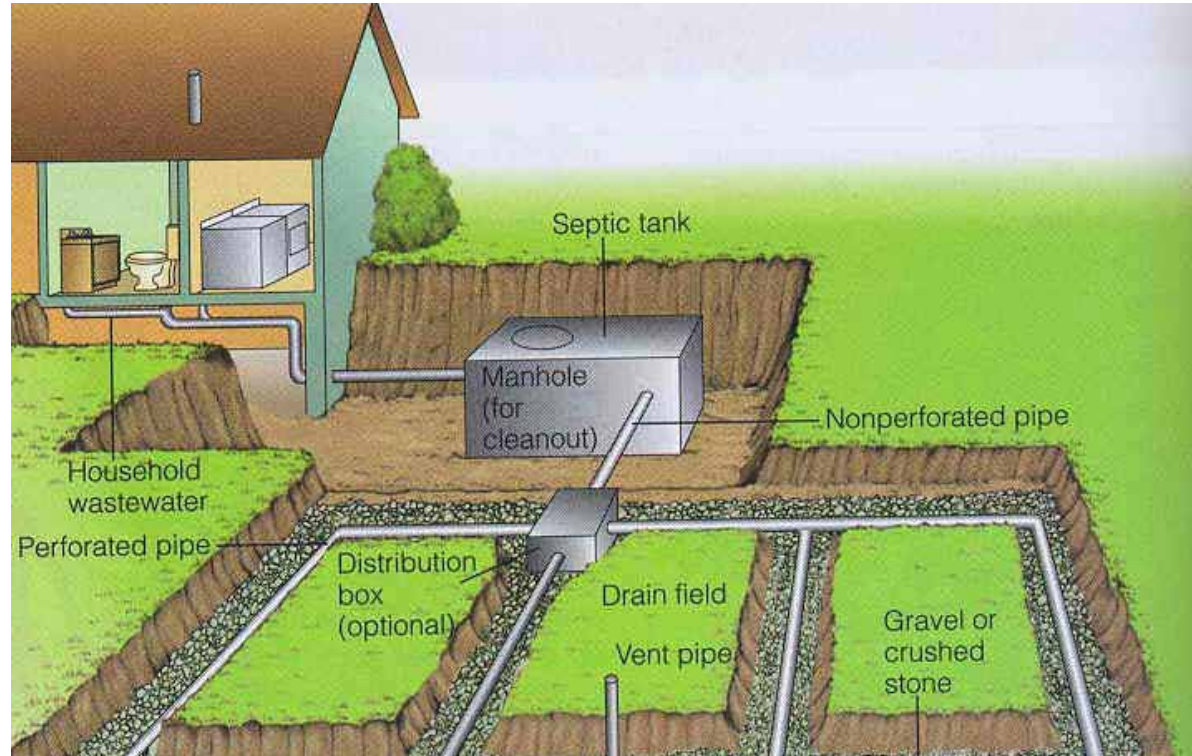

*1,000 – 1,500 gallon septic tank and 300 ft. of drainfield.
(Excludes permitting, and landscape and irrigation repair.)

NEW SEPTIC SYSTEM INSTALLATION



Typical Cap and Fill Residential Septic Installation

Initial Capital Costs:

\$9,500 - \$10,500*

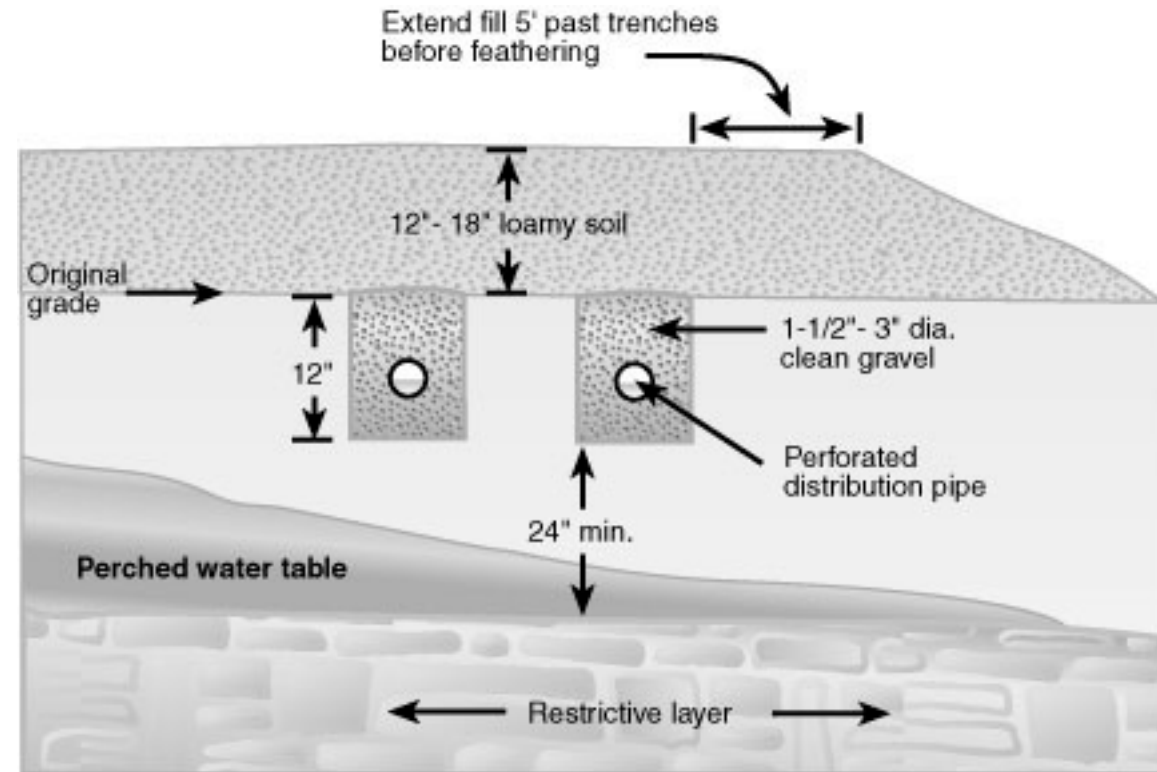

*1,000 – 1,500 gallon septic tank and 300 ft. of drainfield.
(Excludes permitting, and landscape and irrigation repair.)

NEW SEPTIC SYSTEM INSTALLATION



Typical Sand
Filter/ATT
Residential Septic
Installation

Initial Capital
Costs:
\$15,000 - \$20,000*

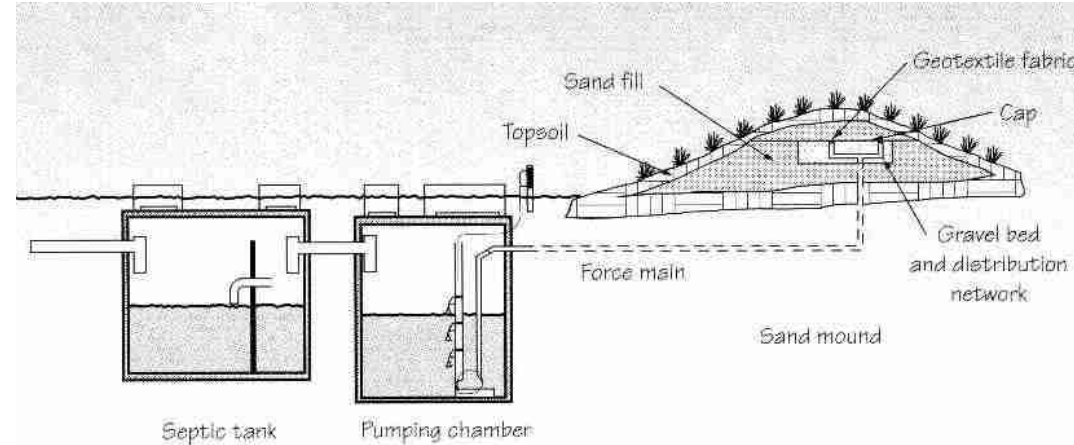

Figure 4. Illustration courtesy of the United States Environmental Protection Agency.

*1,000 – 1,500 gallon septic tank and 300 ft. of drainfield.
(Excludes permitting, and landscape and irrigation repair. Additional \$2,800 - \$3,500 if pumping is required.)

SEPTIC SYSTEM REPAIR



Typical Residential Septic Tank Replacement

Capital Costs:

\$3,800 - \$4,200*

*1,000 – 1,500 gallon septic tank.
(Excludes permitting, and landscape and irrigation repair. Assumes the tank is accessible.)

SEPTIC SYSTEM REPAIR



Typical Residential Drill
Hole Decommission

Capital Costs:
+/- \$5,000

*Excludes new drainfield, and landscape and irrigation repair.





SEPTIC SYSTEM ONGOING MAINTENANCE

Typical Residential Septic Tank Pump-Out

\$300* every 2-5 years

(*If tank is accessible)

		# Year-Round Household Residents							
		1	2	3	4	5	6	7	8
Tank Size (Gallons)	 500	5.8	2.6	1.5	1.0	0.7	0.4	0.3	0.2
	1,000	12.4	5.9	3.7	2.6	2.0	1.5	1.2	1.0
	1,250	15.6	7.5	4.8	3.4	2.6	2.0	1.7	1.4
	1,500	18.9	9.1	5.9	4.2	3.3	2.6	2.1	1.8
	2,000	25.4	12.4	8.0	5.9	4.5	3.7	3.1	2.6

Typical Years Before Pump Out

SEPTIC SYSTEM COSTS



SUMMARY		
System Installation	Standard Septic	\$5,500 - \$6,500
	Cap and Fill	\$9,500 - \$10,500
	Sand Filter/ATT	\$15,000 - \$20,000
	Pressure (Additional)	\$2,800 - \$3,500
System Repair	Tank replacement	\$3,800 - \$4,200
	Drill Hole Decommission	+/- \$5,000
Ongoing Maintenance	Pump-Out (2-5 years)	\$300

UPCOMING MEETINGS ADVISORY COMMITTEE MEETINGS



Thursday, September 7

Solutions in Peer Communities

Thursday, October 5

Preliminary Engineering I

LOOK AHEAD:
SOLUTIONS IN PEER COMMUNITIES
“WHAT WOULD YOU LIKE TO KNOW?”

PUBLIC COMMENT



- 5 minutes
- Time divided among speakers
- Comment cards available



THANK YOU!

REFERENCE WEBSITES



Gravity Sewer <http://www.lsdcm.com/work-with-lsdcm/sewer-connections/existing-property.html>

Pressure to Gravity <http://www.lsdcm.com/work-with-lsdcm/sewer-connections/grinder-pumps.html>

Home Pump to Pressure <http://www.aquapurepumps.net/sewage-pumps/>

Typical Septic System Installation <http://www.oiltankservice.com/id56.html>

Cap and Fill <http://extension.missouri.edu/p/EQ401>

Sand Filter <http://www.aquapurepumps.net/sewage-pumps/>

Septic System Repair <https://plumbing-leaks-faucets.knoji.com/risks-with-underground-oil-and-septic-tanks-home-buying-and-selling/>
<http://www.omniseptic.com/septic-tank-replacement.html>

System Repair Drill Hole <http://www.sprechergroup.com/underground-injection-control-uic/>