

BEND CITYWIDE SAFETY IMPROVEMENTS PROJECT

Making Bend Safer by Design

SE 3RD STREET & CENTRAL OREGON CANAL TRAIL

As a wide street with fast traffic, SE 3rd Street forms an unnecessary barrier between east and west in our community that is difficult and often unsafe to cross. The City of Bend's Citywide Safety Improvements project is working to remove barriers like this and make our streets safer by design.

WHAT IS PLANNED HERE?

- A new marked crosswalk and safety island on the north side of the COID canal at the Central Oregon Canal Trail
- Flashing beacon that warns approaching traffic when activated by someone crossing
- New LED street lighting to illuminate the crossing at night

HOW WILL THESE IMPROVEMENTS HELP?

- Create more frequent and safer crossing opportunities for people
- Better connect neighborhoods, businesses, and other nearby destinations such as the Central Oregon Canal Trail, Fred Meyer, hotels, and more
- Make accessing the Old Farm District neighborhood easier and safer
- Help people to be better seen when crossing the street at night

PROGRAM GOALS



Improve livability and economic vitality



Enhance environment for people to walk



Increase safety for people biking through the area



Preserve mobility for people accessing businesses, transit, and key destinations

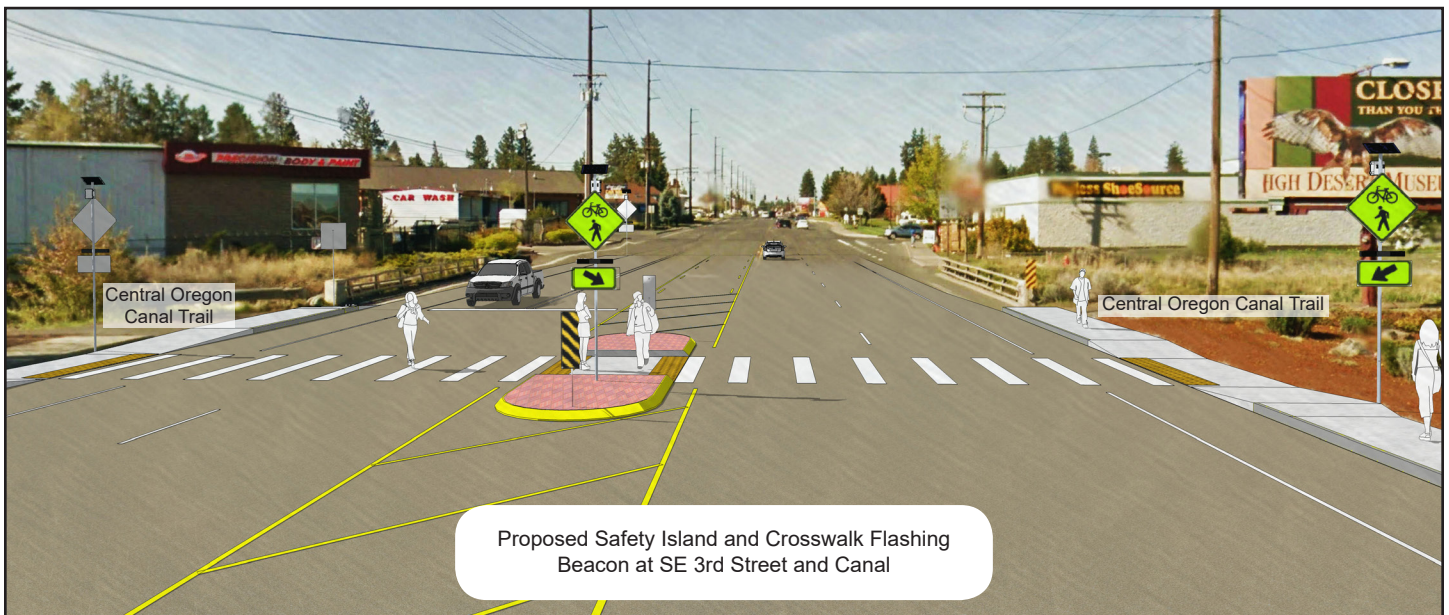

CITY OF BEND

For more information visit: www.bendoregon.gov/safetyimprovements

BEND CITYWIDE SAFETY IMPROVEMENTS PROJECT

Making Bend Safer by Design

SE 3RD STREET & CENTRAL OREGON CANAL TRAIL

WHY HERE AND WHY THESE IMPROVEMENTS?

Beyond being a barrier, 3rd Street has many serious injury and fatal crashes that **CAN** be prevented. Community input and a prior safety study identified a program of safer crossing locations needed along 3rd Street including here and at Roosevelt Avenue, Hawthorne Avenue, and Pinebrook Blvd, among others.

Why SE 3rd Avenue and north side of the canal were chosen:

- Better connects bus stops and nearby destinations
- Few northbound left turns
- Maintains existing driveways for business access
- Helps people traveling along the Central Oregon Canal Trail

Today only 1 in 2 drivers yield to people trying to cross SE 3rd Street in this area. Flashing beacons previously installed on the Bend Parkway, Greenwood Avenue at Pilot Butte, across Oregon and the nation have increased the rate of drivers yielding to people crossing to as high as 80-100%.

These improvements have been proven to make streets safer by design. Collisions with people walking are reduced by:

↓ **47%**  with crosswalk flashing beacons

↓ **39%**  with median safety islands

↓ **42%**  with additional street lighting

Sources: National Complete Streets Coalition, FHWA, ODOT ARTS Program for Bicycle Enhancements, MUTCD Interim Approval for Rectangular Rapid Flashing Beacons, 2008

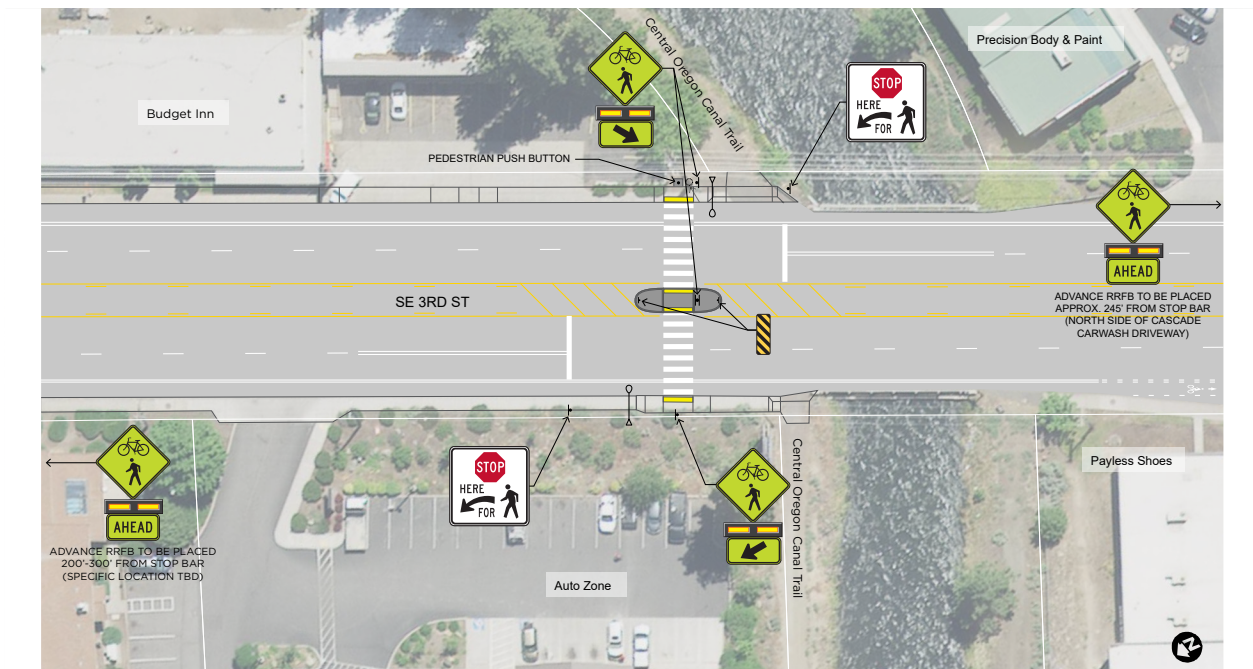

CITY OF BEND

For more information visit: www.bendoregon.gov/safetyimprovements