

NEWPORT CORRIDOR IMPROVEMENTS

SOUTH AWBREY BUTTE

FEBRUARY 2021

LEGEND

 PROJECT AREA



0 250
1 INCH = 250 FT.

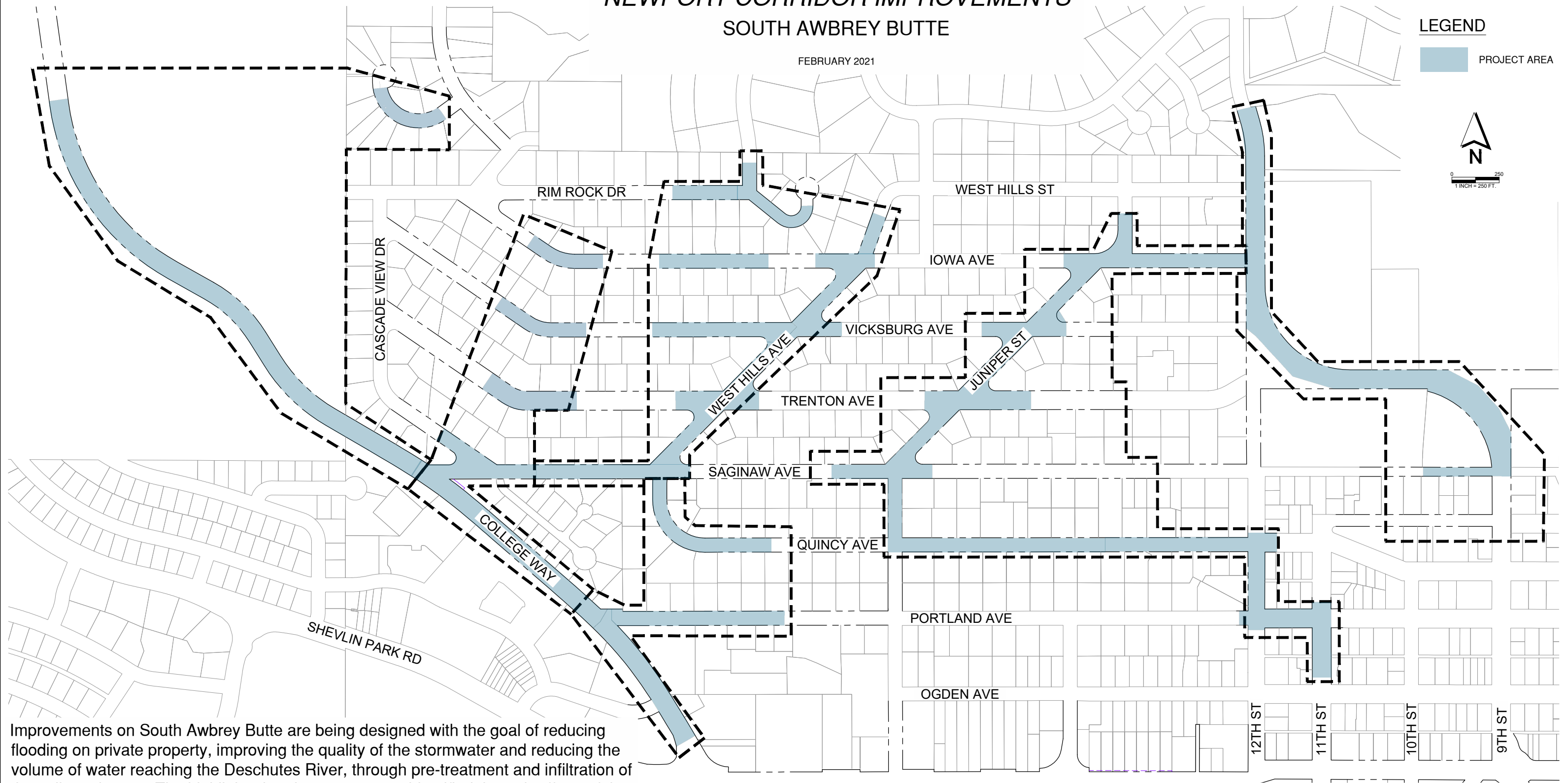

Improvements on South Awbrey Butte are being designed with the goal of reducing flooding on private property, improving the quality of the stormwater and reducing the volume of water reaching the Deschutes River, through pre-treatment and infiltration of the collected water. The highlighted project areas were identified through efforts of the drainage study, completed in 2017 (there is a link to this report on the project website).

What to expect:

- New catch basins and pipes - to collect and convey the stormwater
- Sedimentation manholes and drywells - treatment and discharge of the water back into the ground
- Replacement/strengthening of berms - to reduce the volume of water flowing onto private property



CITY OF BEND

Parametrix
ENGINEERING · PLANNING · ENVIRONMENTAL SCIENCES
150 NW PACIFIC PARK LANE, SUITE 110 | BEND,
OR 97701
P 541.508.7710
WWW.PARAMETRIX.COM

DRAFT CONCEPT
LAYOUT SUBJECT TO REVISION