

36

36

SEPT. 1928
BEND
ORE.

SCALE 100 FT. TO AN INCH

ARIZONA AV.

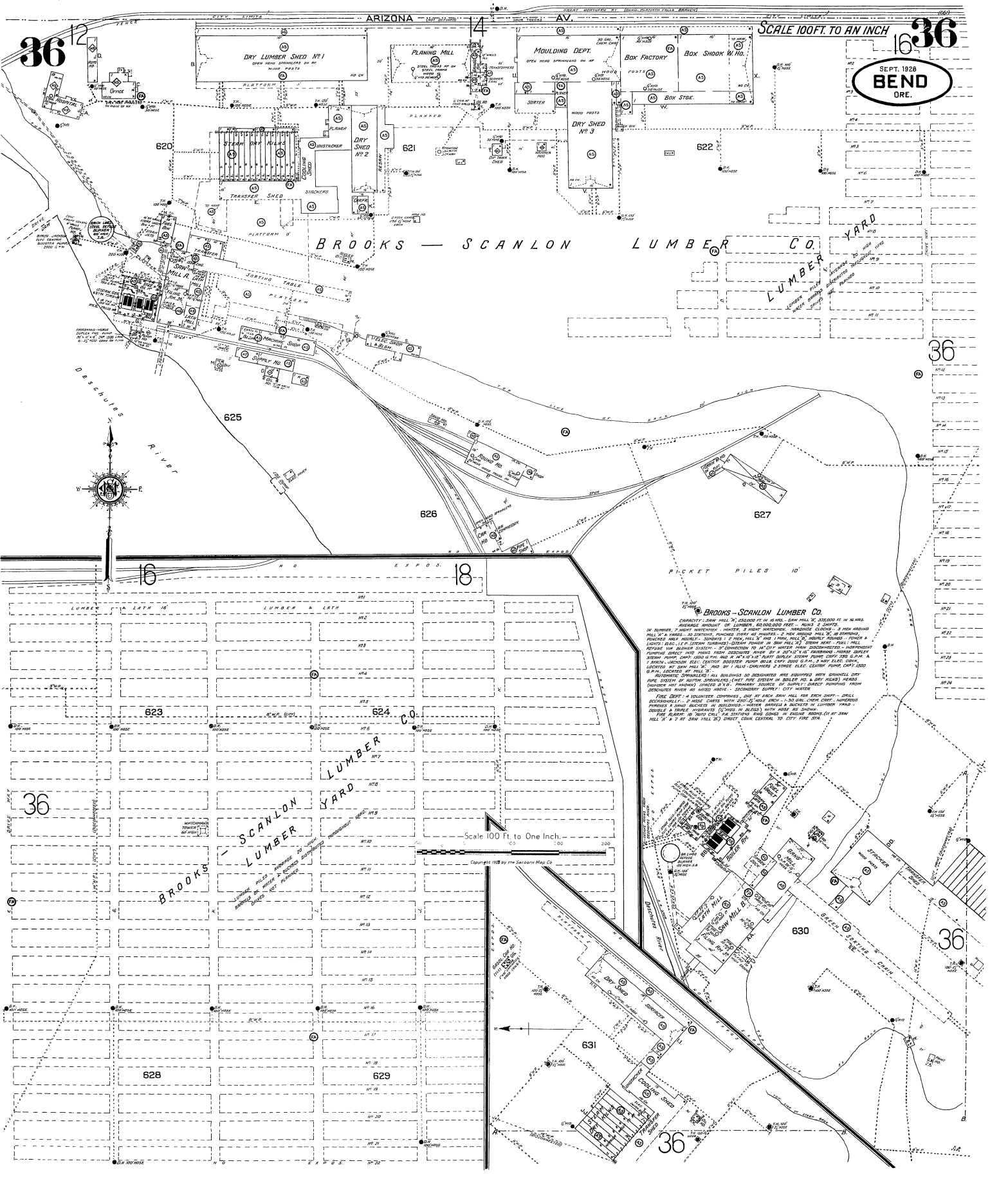

BROOKS — SCANLON LUMBER CO. YARD

BROOKS-SCANLON LUMBER CO.

THE MILL CAPACITY IS 200,000 BOARD FEET PER YEAR. THE MILL IS EQUIPPED WITH THE LATEST AND MOST EFFICIENT MACHINERY. THE MILL IS LOCATED AT THE MOUTH OF THE DESCHUTES RIVER, AND IS ONE OF THE MOST MODERN LUMBER MILLS IN THE WEST. THE MILL IS EQUIPPED WITH THE LATEST AND MOST EFFICIENT MACHINERY. THE MILL IS LOCATED AT THE MOUTH OF THE DESCHUTES RIVER, AND IS ONE OF THE MOST MODERN LUMBER MILLS IN THE WEST.

FIRE DEPT.: A VOLUNTEER COMPANY, ONE AT EACH SHED AND ONE AT THE MILL. THE COMPANY IS EQUIPPED WITH THE LATEST AND MOST EFFICIENT MACHINERY. THE COMPANY IS LOCATED AT THE MOUTH OF THE DESCHUTES RIVER, AND IS ONE OF THE MOST MODERN LUMBER MILLS IN THE WEST.

FIRE ALARMS: A SYSTEM OF FIRE ALARMS IS INSTALLED AT THE MILL AND SHEDS. THE ALARMS ARE LOCATED AT THE MOUTH OF THE DESCHUTES RIVER, AND IS ONE OF THE MOST MODERN LUMBER MILLS IN THE WEST.

FIRE PUMP: A FIRE PUMP IS INSTALLED AT THE MILL AND SHEDS. THE PUMP IS LOCATED AT THE MOUTH OF THE DESCHUTES RIVER, AND IS ONE OF THE MOST MODERN LUMBER MILLS IN THE WEST.

FIRE HOSE: FIRE HOSES ARE INSTALLED AT THE MILL AND SHEDS. THE HOSES ARE LOCATED AT THE MOUTH OF THE DESCHUTES RIVER, AND IS ONE OF THE MOST MODERN LUMBER MILLS IN THE WEST.

FIRE EXTINGUISHERS: FIRE EXTINGUISHERS ARE INSTALLED AT THE MILL AND SHEDS. THE EXTINGUISHERS ARE LOCATED AT THE MOUTH OF THE DESCHUTES RIVER, AND IS ONE OF THE MOST MODERN LUMBER MILLS IN THE WEST.

Scale 100 Ft. to One Inch.

Copyright 1928 by the Searsons Map Co.