

**NORTHWEST TAXILANE MAINTENANCE  
(WORK AREA #1)**

SCALE: 1" = 40'

1  
G-05

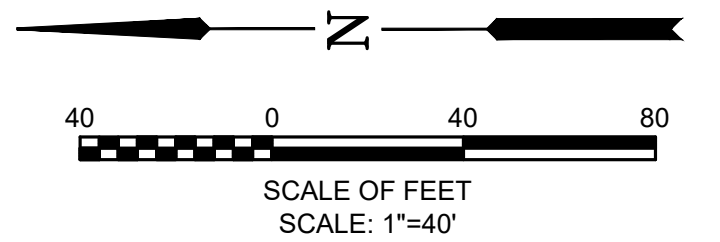

**LEGEND:**

- PAVEMENT MAINTENANCE
- TAXIWAY SAFETY AREA  TSA
- TAXIWAY OBJECT FREE AREA  TOFA
- TAXILANE OBJECT FREE AREA  TLOFA

**NOTES:**

1. FOR PRIVATE HANGARS: BY RULE, THE 50 FEET OF PAVEMENT AREA IN FRONT OF A PRIVATELY-OWNED HANGAR IS CONSIDERED INELIGIBLE FOR FEDERAL FUNDING BY THE FAA. HOWEVER, IF PAVEMENT WITHIN THIS 50-FOOT AREA IS IN THE PUBLIC RIGHT OF WAY (IN THIS CASE, AN ADG-I TAXILANE) THAT PUBLIC PAVEMENT IS ELIGIBLE FOR FEDERAL FUNDING. THE PAVEMENT BETWEEN THE ADG-I TAXILANE EDGE AND THE PRIVATE HANGAR FACE REMAINS INELIGIBLE FOR FEDERAL FUNDING. (TYP ALL.)
2. FOR PUBLICALLY-OWNED HANGARS, THE PAVEMENT BETWEEN THE ADG-I TAXILANE EDGE AND THE HANGAR FACE IS CONSIDERED ELIGIBLE FOR FEDERAL FUNDING BY THE FAA. (TYP ALL.)

THIS PLAN SHEET IS INTENDED TO BE VIEWED IN COLOR. THE FOLLOWING COLORS SHOULD BE DISTINGUISHABLE WHEN PRINTED CORRECTLY:

RED  BLUE

**30% PLANS - NOT FOR CONSTRUCTION**  
A.I.P. NO. 3-41-0037-037-2024



CITY OF BEND

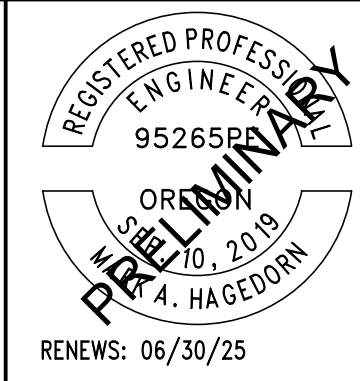

**VERIFY SCALES**  
BAR IS ONE INCH ON ORIGINAL DRAWING.  
0"  1"  
IF NOT ONE INCH ON THIS SHEET, ADJUST SCALES ACCORDINGLY.

NO.	DATE	BY	APPR	REVISIONS



BEND OFFICE  
1020 SW EMKAY DRIVE, #100  
BEND, OR 97702  
541.322.8962  
541.382.2423 FAX

DATE: SEPTEMBER 2024

PROJECT NO: 10051.133.01

DESIGNED BY: MAH  
DRAWN BY: TJS  
CHECKED BY: TH3  
SCALE: AS NOTED

CITY OF BEND  
BEND MUNICIPAL AIRPORT  
TAXILANE MAINTENANCE

---

NORTHWEST TAXILANE MAINTENANCE AREA  
(WORK AREA #1)

DRAWING NO.  
**G-05**

---

SHEET NO.  
**5 OF 25**

X:\Projects\Bend, City 012024 - Taxilane Rehab (Design)\CAD\Exhibits\NW TSA vs 10\G-05\_Work Areas Plan.dwg



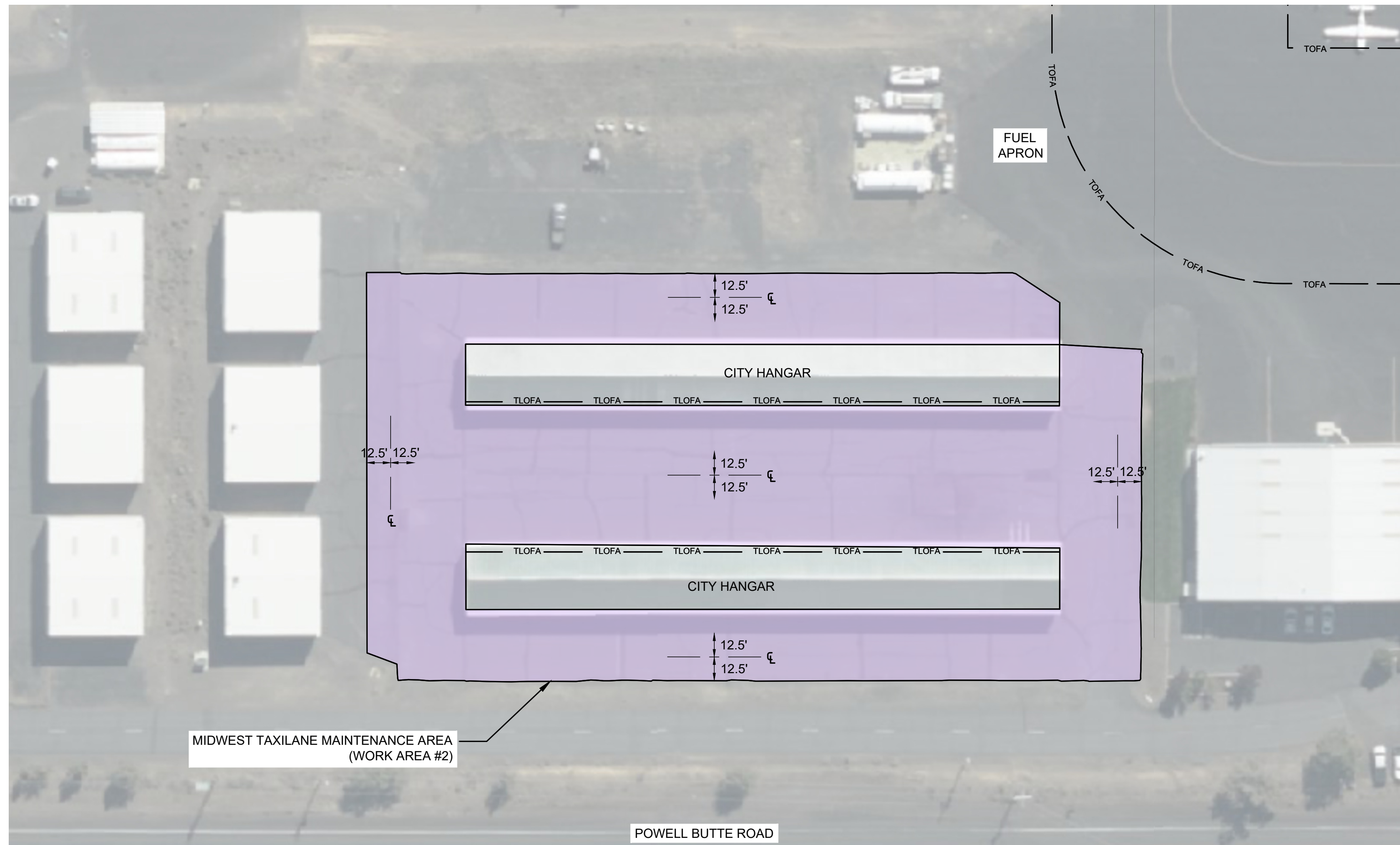

**LEGEND:**

- PAVEMENT MAINTENANCE
- TAXIWAY SAFETY AREA  TSA
- TAXIWAY OBJECT FREE AREA  TOFA
- TAXILANE OBJECT FREE AREA  TLOFA

**MIDWEST TAXILANE MAINTENANCE  
(WORK AREA #2)**

SCALE: 1" = 40'

1  
G-06

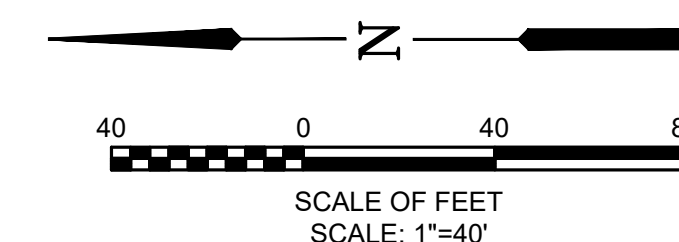

**NOTES:**

1. FOR PRIVATE HANGARS: BY RULE, THE 50 FEET OF PAVEMENT AREA IN FRONT OF A PRIVATELY-OWNED HANGAR IS CONSIDERED INELIGIBLE FOR FEDERAL FUNDING BY THE FAA. HOWEVER, IF PAVEMENT WITHIN THIS 50-FOOT AREA IS IN THE PUBLIC RIGHT OF WAY (IN THIS CASE, AN ADG-I TAXILANE) THAT PUBLIC PAVEMENT IS ELIGIBLE FOR FEDERAL FUNDING. THE PAVEMENT BETWEEN THE ADG-I TAXILANE EDGE AND THE PRIVATE HANGAR FACE REMAINS INELIGIBLE FOR FEDERAL FUNDING. (TYP ALL.)
2. FOR PUBLICALLY-OWNED HANGARS, THE PAVEMENT BETWEEN THE ADG-I TAXILANE EDGE AND THE HANGAR FACE IS CONSIDERED ELIGIBLE FOR FEDERAL FUNDING BY THE FAA. (TYP ALL.)

THIS PLAN SHEET IS INTENDED TO BE VIEWED IN COLOR. THE FOLLOWING COLORS SHOULD BE DISTINGUISHABLE WHEN PRINTED CORRECTLY:

RED  BLUE

**30% PLANS - NOT FOR CONSTRUCTION**  
AIP. NO. 3-41-0037-037-2024



CITY OF BEND

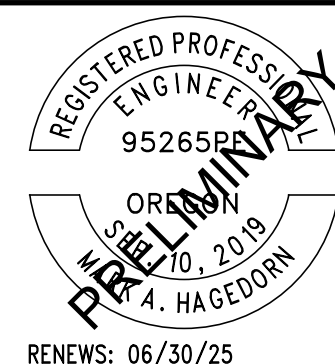

**VERIFY SCALES**  
BAR IS ONE INCH ON ORIGINAL DRAWING.  
0"  1"  
IF NOT ONE INCH ON THIS SHEET, ADJUST SCALES ACCORDINGLY.

NO.	DATE	BY	APPR	REVISIONS



BEND OFFICE  
1020 SW EMKAY DRIVE, #100  
BEND, OR 97702  
541.322.8962  
541.382.2423 FAX

DATE: SEPTEMBER 2024

PROJECT NO: 10051.133.01

DESIGNED BY: MAH  
DRAWN BY: TJS  
CHECKED BY: TH3  
SCALE: AS NOTED

CITY OF BEND  
BEND MUNICIPAL AIRPORT  
TAXILANE MAINTENANCE

MIDWEST TAXILANE MAINTENANCE AREA  
(WORK AREA #2)

DRAWING NO.  
**G-06**  
SHEET NO.  
6 OF 25



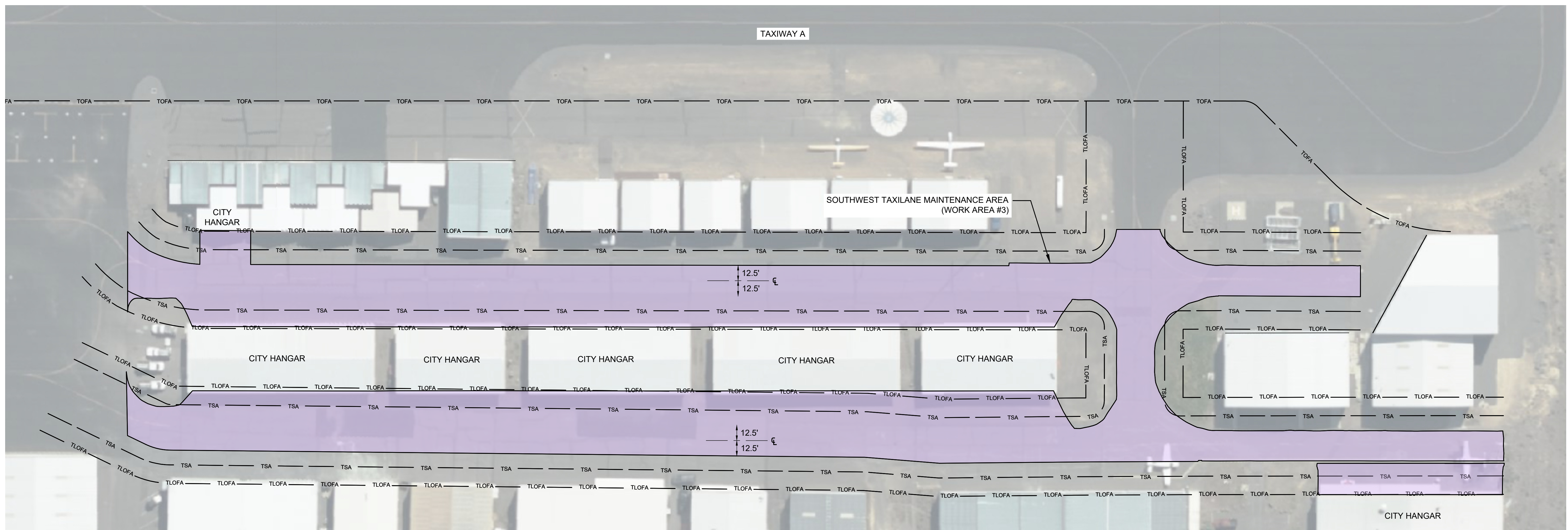

**SOUTHWEST TAXILANE MAINTENANCE AREA  
(WORK AREA #3)**

SCALE: 1" = 40'

1  
G-07

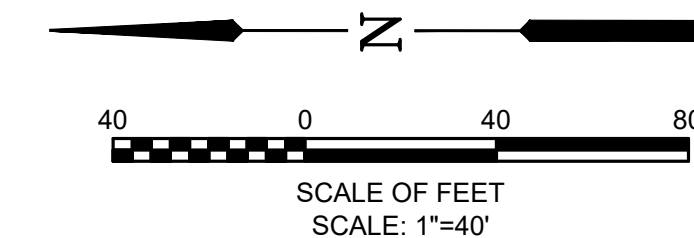

**LEGEND:**

- PAVEMENT MAINTENANCE
- TAXIWAY SAFETY AREA  TSA
- TAXIWAY OBJECT FREE AREA  TOFA
- TAXILANE OBJECT FREE AREA  TLOFA

**NOTES:**

1. FOR PRIVATE HANGARS: BY RULE, THE 50 FEET OF PAVEMENT AREA IN FRONT OF A PRIVATELY-OWNED HANGAR IS CONSIDERED INELIGIBLE FOR FEDERAL FUNDING BY THE FAA. HOWEVER, IF PAVEMENT WITHIN THIS 50-FOOT AREA IS IN THE PUBLIC RIGHT OF WAY (IN THIS CASE, AN ADG-I TAXILANE) THAT PUBLIC PAVEMENT IS ELIGIBLE FOR FEDERAL FUNDING. THE PAVEMENT BETWEEN THE ADG-I TAXILANE EDGE AND THE PRIVATE HANGAR FACE REMAINS INELIGIBLE FOR FEDERAL FUNDING. (TYP ALL.)
2. FOR PUBLICALLY-OWNED HANGARS, THE PAVEMENT BETWEEN THE ADG-I TAXILANE EDGE AND THE HANGAR FACE IS CONSIDERED ELIGIBLE FOR FEDERAL FUNDING BY THE FAA. (TYP ALL.)

THIS PLAN SHEET IS INTENDED TO BE VIEWED IN COLOR. THE FOLLOWING COLORS SHOULD BE DISTINGUISHABLE WHEN PRINTED CORRECTLY:

RED  BLUE

**30% PLANS - NOT FOR CONSTRUCTION**  
AIP. NO. 3-41-0037-037-2024



CITY OF BEND



RENEWS: 06/30/25

**VERIFY SCALES**  
BAR IS ONE INCH ON ORIGINAL DRAWING.  
0"  1"  
IF NOT ONE INCH ON THIS SHEET, ADJUST SCALES ACCORDINGLY.

NO.	DATE	BY	APPR	REVISIONS



BEND OFFICE  
1020 SW EMKAY DRIVE, #100  
BEND, OR 97702  
541.322.8962  
541.382.2423 FAX

DATE: SEPTEMBER 2024

PROJECT NO: 10051.133.01

DESIGNED BY: MAH  
DRAWN BY: TJS  
CHECKED BY: TH3  
SCALE: AS NOTED

CITY OF BEND  
BEND MUNICIPAL AIRPORT  
TAXILANE MAINTENANCE

SOUTHWEST TAXILANE MAINTENANCE AREA  
(WORK AREA #3)

DRAWING NO.  
**G-07**  
SHEET NO.  
7 OF 25